

 **NightSearcher**

**Hawk-Star
Hawk-Star X**

**Rechargeable LED
Searchlight**



USER MANUAL
www.nightsearcher.co.uk

Thank you for purchasing the NightSearcher Hawk-Star/ Hawk-Star X rechargeable searchlight, our latest innovation offering an all-in-one solution that combining a high performance searchlight and powerful wide angled floodlight in a single lightweight, compact unit.

Important: Please read these instructions carefully to ensure the safe and effective use of this product.

Index

Page 2: Parts

Page 3-4: Quick start guide, Battery status indicators, Emergency Function

Page 5: Mounting the charging base, Attaching the shoulder strap

Page 6: Operating the Hawk-Star

Page 7: Specification

Page 8: Important warnings, Safe disposal of waste electrical products
Warranty terms

Parts

- 1 Narrow beam
- 2 Wide beam
- 3 On/Off/Mode Button
- 4 Adjustable stand
- 5 Battery status and charging indicator
- 6 Charging base
- 7 DC Charger



* Optional shoulder strap and AC Charger is available.



Quick Start Guide - Charging



1. Slide the Hawk-Star inside the charging base, push until it slots in the back and connects with the charging ports.



2. Connect the charger lead into the input socket at the back of the charging base.



3A. Plug the vehicle charger into the car cigarette socket. The indicator on the charger will illuminate red when charging and green when fully charged.

OR



3B. Plug the charger into a suitable socket outlet. Turn switch on. The indicator on the charger will illuminate red when charging and green when fully charged.

Note: AC charger is an optional accessory (not supplied with the HawkStar/X)



4. The battery indicator will illuminate from Red (Low battery)---Amber---Green (fully charged). The lights will turn off once fully charged. When the Hawk-Star is charged unplug and remove the charging lead. Recharge for 6.5 hours HawkStar, and 8 hours HawkStar-X.

Quick Start Guide - Charging Continued...



5. To release the Hawk-Star from the charging base, hold and pull the release levers towards you, use your thumb to push the searchlight away from the charging slot as shown in picture.



6. Once the Hawk-Star is released slide the searchlight out of the charging base. The Hawk-Star is ready to be used.



Please note:

The battery will reach optimum performance after 5 complete discharge/charge cycles.

Battery Status Indicators



When the Hawk-Star is switched ON, the battery indicator will illuminate for 5 seconds to show the battery status.

-  Green: Full Battery
-  Amber: Half Battery
-  Red: Low Battery

Emergency Function

The HawkStar/-X has an emergency function to automatically illuminate in the event of a power cut. To use this function, turn the search light on and place in the charging base. Switch on the charger, in the event of a power cut the HawkStar will illuminate to aid the lights location.

Mounting The Charging Base

The Hawk-Star is supplied with a charging base, providing a convenient way to charge it. The base can be used flat on a desk, or fixed on a wall or a vehicle. The charging base has four mounting holes, measurements are shown in Fig 1. Make sure the M5 fixings screws used to mount the charging base, are strong enough to support the weight of the Hawk-Star. Take care not to over tighten the fixings and mount on a flat/level surface, so the charge base isn't distorted or damaged.

Fig 1.

MOUNT USING FOUR M5 FIXING SCREWS

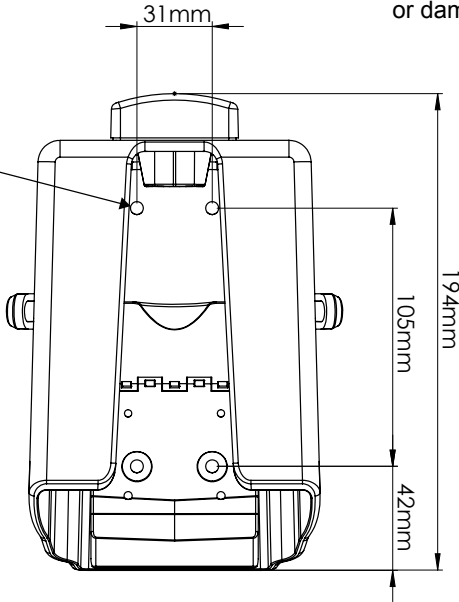

Holder may be mounted on either a horizontal or vertical panels.

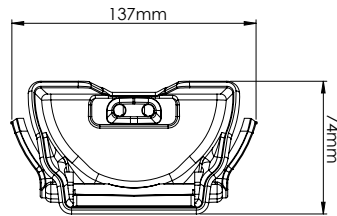
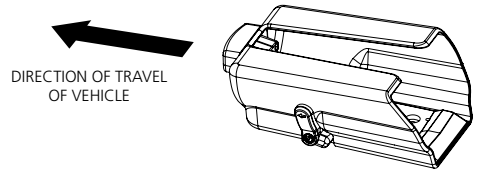

Fig 2. Attaching Shoulder Strap



A optional shoulder strap is available to buy, making it comfortable to carry the searchlight, whilst keeping your hands free to perform other tasks. See Fig 2. showing the fitting and removing of the strap.

Operating The Hawk-Star

To switch ON, simply press the grey button and the Hawk-Star will default to **Mode 1**: Full narrow light. It has 7 other light modes, please follow the diagram below to activate the required light mode.

Hawk-Star Light Modes:

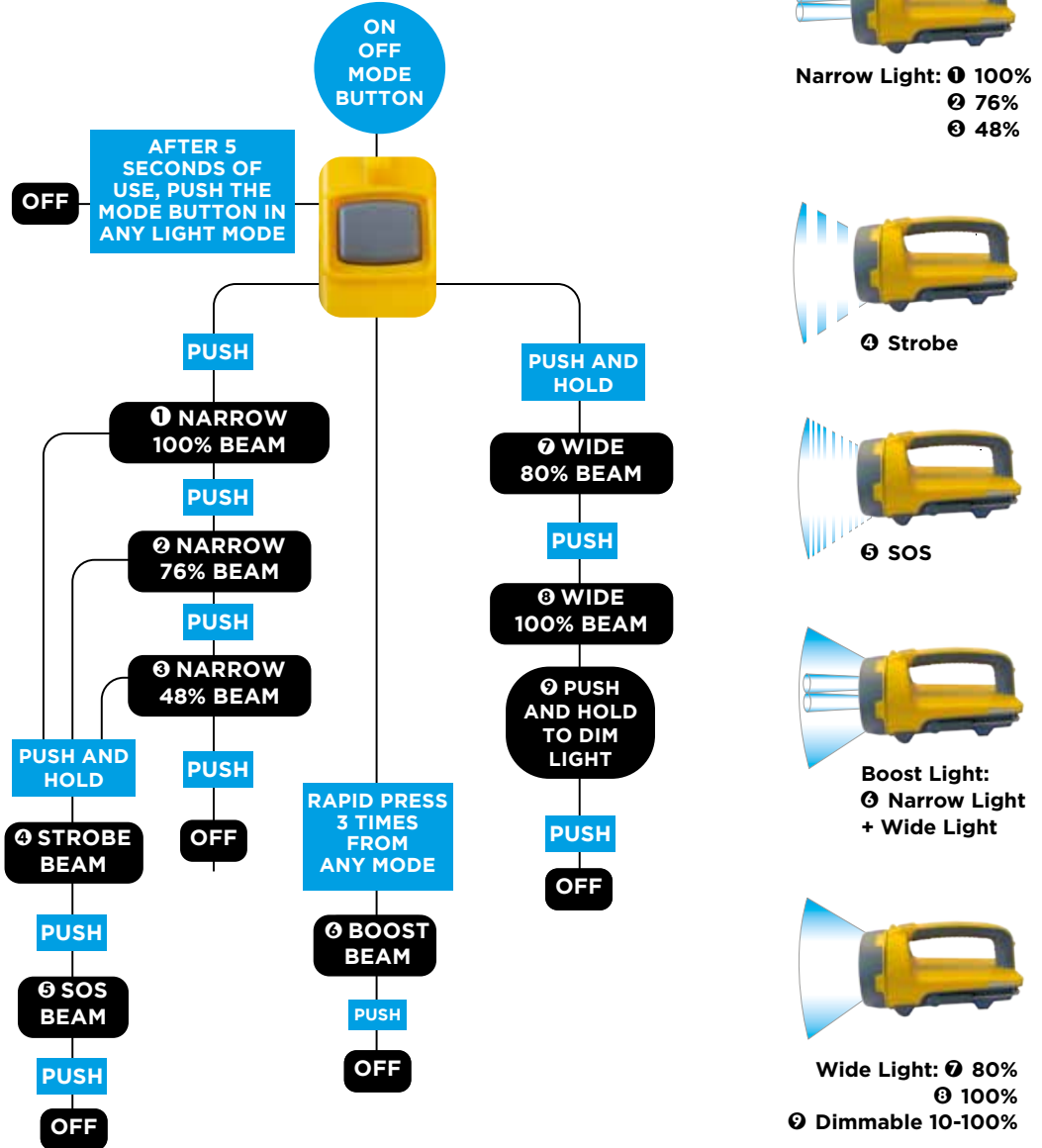

Specification:

Hawk-Star:

Hawk-Star X:

Mode		Lumens	Runtime	Lumens	Runtime
Boost	Narrow + Wide beam	2,250	3hrs 30mins	4,200	4hrs 30mins
Search	100%	1,250	7hrs	2,200	7hrs 15mins
	76%	950	8hrs	1,300	9hrs 45mins
	48%	600	9hrs 30mins	900	12hrs 30mins
Flood	100%	1,000	6hrs 30mins	2,000	7hrs 30mins
	80%	800	7hrs 30mins	1,250	9hrs 45mins
Charging time	6hrs 30mins			8hrs	
IP Rating	IP65			IP65	
Battery	7.4V 6.6Ah Li-ion			7.4V 10.2Ah Li-ion	
Impact Resistant	1.5 Metres			1.5 Metres	
Supplied with	Charging Base and Vehicle charger				
Product Code	NSHAWKSTAR			NSHAWKSTAR-X	
Dimensions	250x(W)125x(D)120mm				
Weight	1.0KG			1.1KG	

Important Warnings

- Read manual before use.
- Always use the charger supplied, never use a damaged charger or alternative charger.
- Disconnect from any power sources and switch off, before performing any routine cleaning or maintenance.
- Leave servicing to a qualified person. In case of any problems or questions please contact NightSearcher Limited or an authorised distributor.
- Do not shine the light directly into people's eyes, as it may damage their eyesight.
- Keep out of reach of children.

Safe disposal of waste electrical products and batteries



If at any time, you need to dispose of this product or parts of this product: please note that waste electrical products and batteries should not be disposed of with ordinary household waste. Recycle where facilities exist. Check with your local authority for recycling advice. Alternatively, NightSearcher is happy to take receipt of this product at end-of-life and will recycle it on your behalf.

Warranty:

All NightSearcher products have a 3-year standard warranty on all manufacturing defects and 1-year warranty on all rechargeable batteries from the date of purchase.



Extended Warranty: From 1st September 2018, customers have the option to extend the warranty of the product to 5 years for manufacturing defects. Registration of the product must be made within one month of purchase by sending us an email sales@nightsearcher.co.uk. In the message please state in your own words that you would like to register your NightSearcher product for the extended warranty. **To view NightSearcher's warranty policy, please visit: <http://nightsearcher.com/en/warranty.html> or scan the QR code.**



NightSearcher Ltd
Unit 4, Applied House
Fitzherbert Spur
Farlington
Portsmouth
Hampshire
PO6 1TT, UK



Tel: 023 9238 9774
www.nightsearcher.co.uk



@nightsearcher-limited



@NightSearcherLtd



nightsearcher-limited



@NightSearcher