

GENZERO

PORTABLE POWER STATIONS

GZ-600W-230V/-EU

User Manual

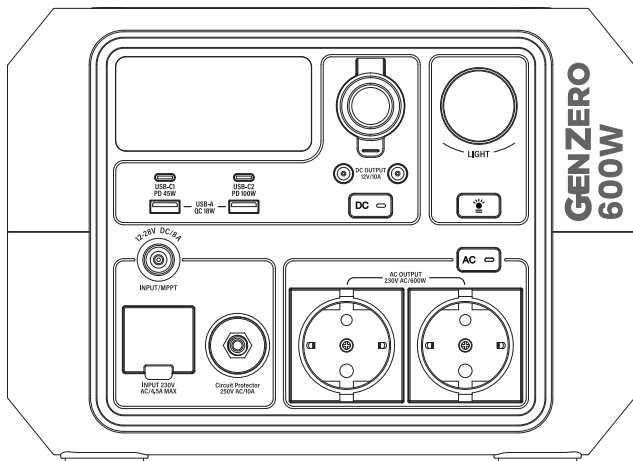

Product Description

- This product supports DC,AC,USB and Type-C connectivity for a wide range of devices, so you never lose power while working, resting or playing. whether you are exploring the great outdoors, hosting a party or experiencing the unexpected power outage, this product will constantly provide you with clean and reliable power, doing its part to help you reduce carbon emissions to the environment.
- The product has built-in lithium iron phosphate battery pack, supports AC 230V/50Hz 600W pure sine wave output, multi-function DC port output, and configures AC 160W direct charging function. It also supports 7909 port DC/PV 12V-28V 8A 200W DC charging mode with MPPT function. The product has UPS function.

It Can be used to charge the following products



GPS Watch



Phone



iPad



Laptop



Camera



Projector



LED Light



Fan



Drone



Game Console



Mini fridge



Electric tool

Diagram

Front View

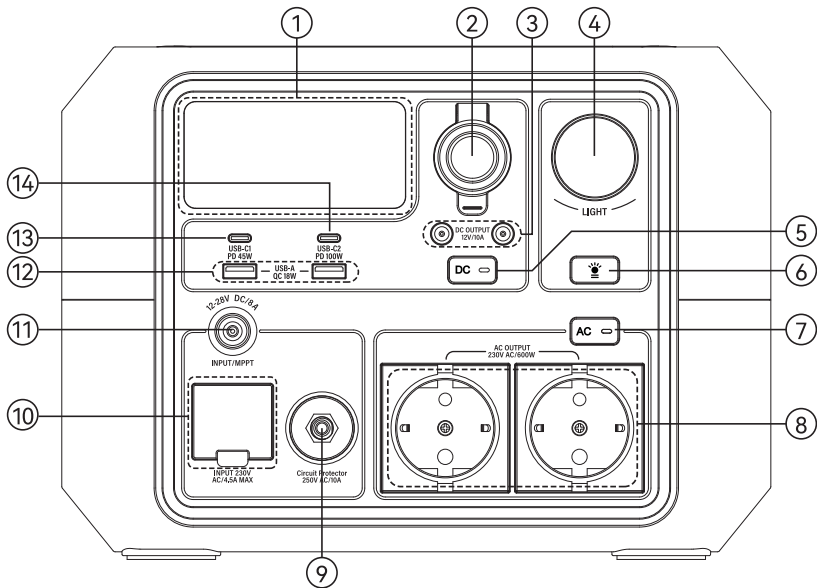

- | | | |
|-------------------|-------------------------|---------------------|
| ① LED Screen | ② Car Cigarette lighter | ③ DC Output ×2 |
| ④ Emergency Light | ⑤ DC ON/OFF | ⑥ Light ON/OFF |
| ⑦ AC ON/OFF | ⑧ AC Output ×2 | ⑨ Circuit Protector |
| ⑩ AC Input | ⑪ MPPT Input | ⑫ USB A Output |
| ⑬ USB-C1 Output | ⑭ USB-C2 Output | |

Operating Instructions

Pushbutton Guide

Individual button operation

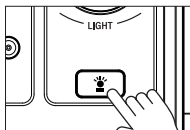

POWER Key (Same key as LED light button)

- ① Short press once to turn on the machine. After the machine is turned on, the display screen lights up and shows information such as power and remaining power.
 - ② Press and hold for 3s again to turn off the machine. In the case of charging input, long press can not turn off the machine, unplug the charging device first to turn off the machine normally.
 - ③ If no operation is performed within one minute after power on, the machine will automatically shut down.
- * The power button, AC button, and DC button can all be used to turn on and off the product. (Short press once to turn on, long press for 3 seconds to turn off)

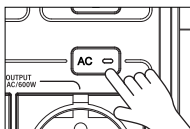

AC OUT Key

- ① Short press once to turn on the AC output, the AC LED will light up (green) and the AC icon will be displayed on the screen.
- ② one more short press to turn off the AC output, the AC LED goes out and the icon on the display screen is not displayed.

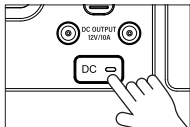

DC OUT, USB OUT Key

- ① Short press once to turn on the DC output, the DC LED lights up (green) and the icon on the display screen is displayed.
- ② Short press once to turn off the DC output, the DC LED indicator is off, and the icon on the display screen is not displayed.

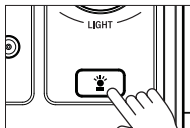

LED light Key

- ① The screen lights up on the basis of a short press once to turn on the LED. in turn short key, the LED lights up in the following order: low on - high on - SOS.
- ② SOS distress signal: 3 short, 3 long and 3 short:
On for 200ms, off for 200ms, on for 200ms, off for 200ms, on for 200ms, off for 800ms;
On for 600ms, off for 400ms, on for 600ms, off for 400ms, on for 600ms; off for 800ms;
On for 200ms, off for 200ms, on for 200ms, off for 200ms, on for 200ms and off for 2000ms.

Functions of screen display and indicator

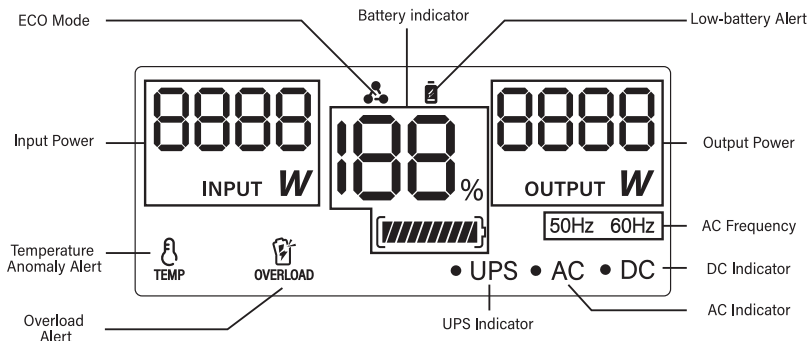

	Power on display	<ul style="list-style-type: none"> When the power switch is turned on, all characters and icons are displayed. When no input and output work is performed, the current power is displayed as 0. If there is no operation, it will turn off automatically after one minute.
	Input Display	Displays the current input power when passing through the AC input/DC input.
	Output Display	When single port or multiple ports are output at the same time, the power of single port or total output power is displayed.
	ECO mode	ECO mode activated, ECO mode can be turned off by setting.
	Low-battery Alert	The screen will display a low battery alert when the product is below 10% power.
50Hz 60Hz	AC Frequency	50Hz/60Hz is the current output frequency, you can short press the AC button and DC button for about 2 seconds to enter the mode setting interface, then short press the AC button to change the output frequency.
	Temperature Anomaly Alert	When the product has high and low temperature protection, the screen will display abnormal temperature alarm.
	Overload Alert	The screen will display an overload alarm when the output power of a single port or multiple ports at the same time exceeds the power that can be carried by the battery.

• UPS	UPS mode	Connect the product to AC power via the AC charging cable, plug the electrical device into the product's AC power output port, and turn on the AC switch to automatically switch to entry-level UPS mode.
• AC	AC Indicator	When the AC output is on, the indicator light is on. When off, the indicator goes off.
• DC	DC Indicator	When the DC output is on, the indicator light is on. When off, the indicator goes off.

Charging method

Solar panel charging (Not supplied)

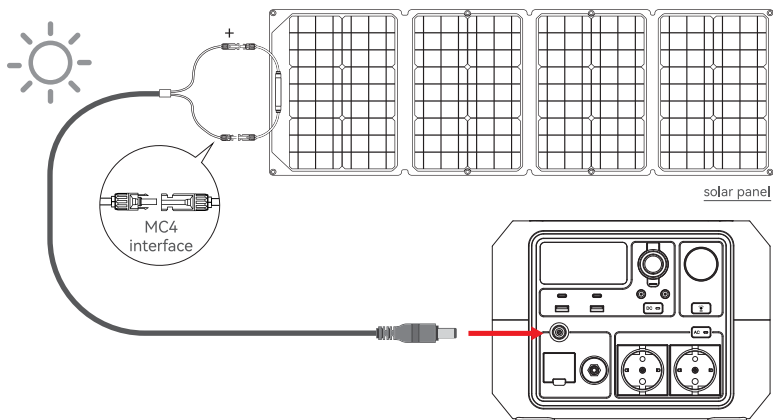

3.3.2 Charging with a wall AC power outlet

Connect the AC power cord input plug to the wall outlet and the other end to the AC charging input port of this product.

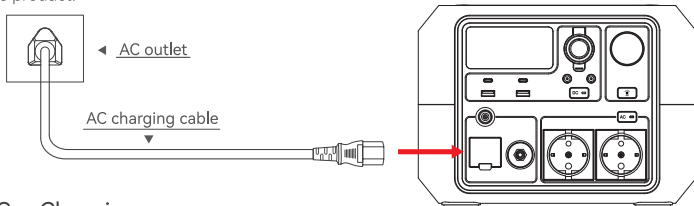

3.3.3 Car Charging

Connect this product to the car 12V/24V cigarette lighter port via the car charging cable.

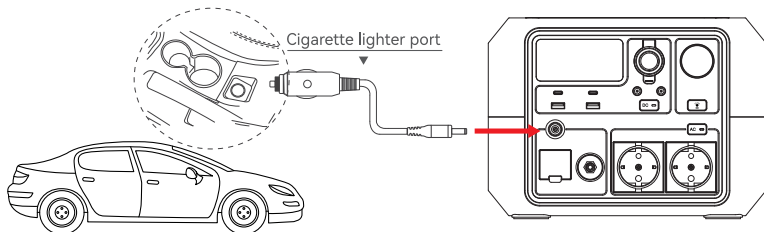

⚠ WARNING: Failure to fully insert the cigarette lighter tip into the machine's cigarette lighter port may result in a safety issue.

3.4 Introduction to UPS functions

This product has an entry-level UPS function, which means you can use the AC outlet of the product to charge your equipment while connected to the wall AC power (your equipment is powered by AC power, not the product's battery). In the event of a sudden AC power failure, the power can be switched to the product's battery within 15 ms.

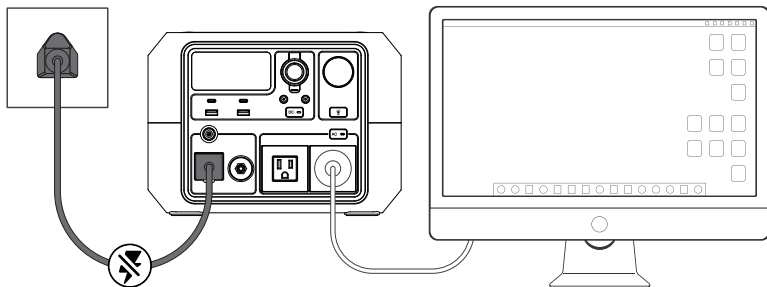

Connect the product to AC power via the AC charging cable, plug electrical equipment into the product's AC power output port, and turn on the AC switch to automatically switch to entry-level UPS mode. When the AC power supply is disconnected, the product can continue to supply power to the equipment.



1. UPS function only supports less than 600W power equipment and do not use other equipments at the same time to avoid overload; the UPS function can only be connected to one device and does not support multi-device connection.
2. This function is not a professional-level UPS function and does not support 0ms switching. Please test your equipment several times to make sure it is compatible before using it. Otherwise, it will affect your experience. In addition, do not connect to equipments with high uninterruptible power supply requirements, such as data servers and workstations. We are not responsible for the failure of the equipment to operate correctly or the loss of data if it is not operated according to the instructions.

SPECIFICATION

Model	
Battery Capacity	537.6Wh,22.4V,24Ah
Battery Type	LiFePO4
dimensions (L×W×H)	10.94×8.13×7.93in / 278×206.6×201.3mm
Weight	15.87 lbs/7.2kg
Operating Temperature	14~104°F (-10~40°C)
Storage Temperature	14~113°F (-10~45°C)
LED Lighting	1W (low, high, SOS)
Inverter Type	Pure Sine Wave
AC Output × 2	
Output Power	Total 600W
Rated Output Voltage	230VAC
Rated Output Current	2.6A
Rated Output Frequency	50/60Hz
DC Output	
USB-A ×2	5V=3A,9V=2A,12V=1.5A,Total 18W
USB-C1	5V=3A,9V=3A,12V=3A,15V=3A,20V=2.25A, Total 45W
USB-C2	5V=3A,9V=3A,12V=3A,15V=3A,20V=5A, Total 100W
DC Outlets	12V=10A×1(car),12V=10A×2(DC5.5mm) Total 120W
AC Input	
Input Power	160W Max
Rated Input Voltage	230VAC
Input Frequency	60Hz
DC Input	
Input Power	200W Max (MPPT)
Input Voltage Range	12-28VDC
Max. Input Current	8A

Packing list

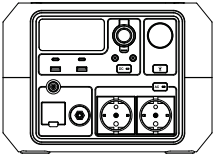
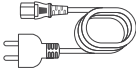
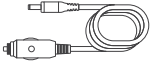
Standard Accessories

Designation	Diagram	Quantity
Portable Power Station		1
AC charging cable		1
Car charging cable		1
Instruction manual		1

IMPORTANT SAFETY INFORMATION:

- To ensure heat dissipation, please make sure at least 5cm space around the generator for smooth airflow.
- Never submerge in water.
- If you suspect the unit has water inside, do not use or attempt to recharge.
- Dropping the Generator may damage the battery or circuit components inside.
- IF THE Generator HAS BEEN SUBMERGED IN WATER OR SUSTAINED DAMAGE IT COULD BE A FIRE HAZARD. DO NOT USE THE PRODUCT.
Place outdoors in a non-combustible container well away from flammable materials.
DO NOT RECHARGE THE BATTERY AND CONTACT NIGHTSEARCHER.
Place the generator outdoors in a non-combustible container well away from flammable materials and contact: www.nightsearcher.co.uk
+44 (0)2392 389774.
- Always recharge the generator on a hard, flat, heat resistant surface.
- The battery will not reach optimum performance until 4-5 charging cycles
- Do not turn the generator off immediately after use, only turn off once the fan has stopped running.
- Avoid charging the battery in temperatures below 0°C or exposing the battery to temperatures below -5°C or above 40°C.
- Never use the charger if the leads, contacts or casings are damaged. Do not use any chargers other than those provided.
- Never expose the charger to rain, moisture or damp. If you suspect any of these have occurred then do not use the charger.
- Always check with your airline before attempting to transport by air.
- We recommend the generator is recharged every 3 months if not used for a long time.
- Keep out of reach of children.
- In case of any problems or questions please contact NightSearcher Limited or an authorised distributor.

Warranty



All NightSearcher products have a 10-year standard warranty on all manufacturing defects and 5-year warranty on all rechargeable batteries from the date of purchase. For more information visit: <https://nightsearcher.co.uk/pages/warranty-information>

If at any time, you need to dispose of this product or parts of this product: please note that waste electrical products and batteries should not be disposed of with ordinary household waste. Recycle where facilities exist. Check with your local authority for recycling advice. Alternatively, NightSearcher is happy to take receipt of this product at end-of-life and will recycle it on your behalf.



NightSearcher Limited
Unit 4 Applied House, Fitzherbert Spur, Farlington,
Portsmouth, Hampshire, PO6 1TT, UK
T: +44 (0)23 9238 9774 | E: sales@nightsearcher.co.uk
W: nightsearcher.co.uk

Nightsearcher Lichttechnik GmbH Stadtweide 17 Emmerich am Rhein Kleve 46446 Deutschland

